

Front boiler support.
Dotted line shows position of frame spacer
Bolt to frame spacer

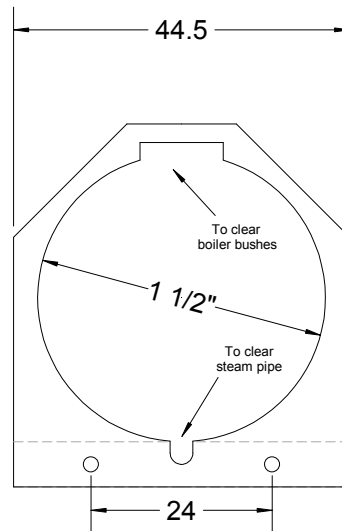

Rear boiler support
Dotted line shows position of frame spacer
Bolt to frame spacer

Boiler supports can be thin brass or steel sheet.
Thickness is not critical, say 0.5mm or 24 SWG.

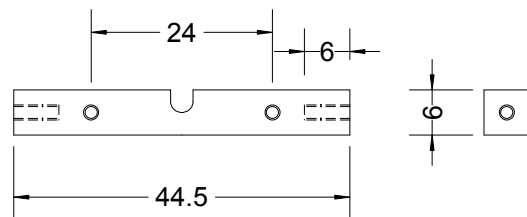

Frame spacer (2 off), 6mm square
mild steel or brass
Drill holes 1.4, tap 10BA
Central notch 3mm deep to clear steam pipe

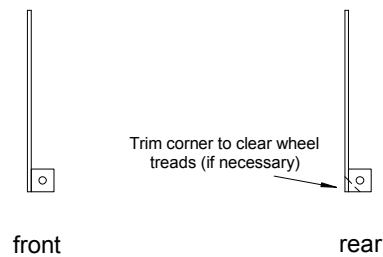

Assembled boiler supports and
frame spacers, half full size

Wild Rose III
sheet 15
Boiler supports (gas fired boiler)